

# OEM Series: Cable-Extension Position Transducer

## Incremental Encoder Output

Ranges: 0-25, 0-150 in. • 0-625, 0-3750 mm

Compact Size • OEM Applications

# PTX150

### Specification Summary:

#### GENERAL

Full Stroke Range Options ..... 0-25 to 0-150 in., 0-625 to 0-3750 mm  
 Output Signal ..... incremental encoder (quadrature)  
 Accuracy ..... *see ordering information*  
 Repeatability ..... *see ordering information*  
 Resolution Options ..... 25 to 1250 pulses per inch  
 Measuring Cable ..... 0.019-in. dia. nylon-coated stainless steel  
 Enclosure Material ..... anodized aluminum  
 Sensor ..... optical encoder  
 Weight ..... 1 lb. max.

#### ELECTRICAL

Input Voltage ..... *see ordering information*  
 Input Current ..... *see ordering information*  
 Electrical Connection ..... 18" multiconductor cable

#### ENVIRONMENTAL

Enclosure ..... NEMA 1  
 Operating Temperature ..... 0° to 160°F (-17° to 71°C)  
 Vibration ..... up to 10 G's to 2000 Hz maximum



The PTX150 is a low cost, compact and easy to use encoder based cable-extension transducer. It is available with full stroke ranges up to 150 inches. The PTX150 provides an incremental encoder feed-back signal.

Simply mount the body of the transducer to a fixed surface and attach the extension cable to the moving object. The PTX150 is recommended for application where space and money is limited.

Outline (0-25, 0-50 in. range)

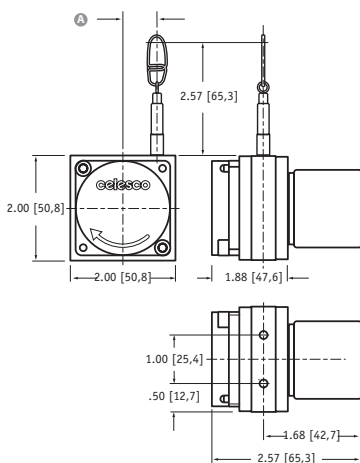

range	dim.
25 in. = 625 mm	0.34 [8,6]
50 in. = 1250 mm	0.64 [16,2]

All Dimensions are in INCHES [MM] tolerances are ±0.03 in. [0,8 mm]

Outline (0-100, 0-150 in. range)

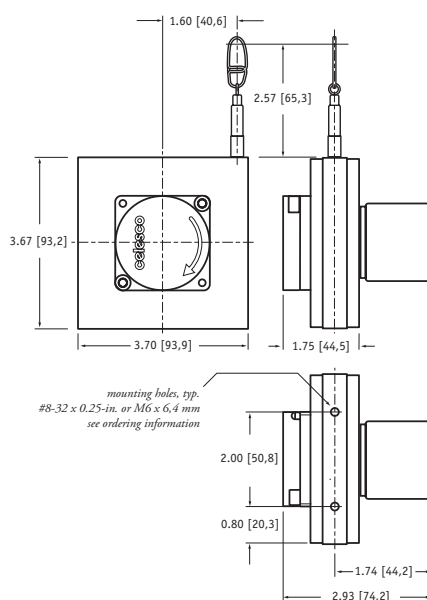

### Output Signal

