

MODEL 60064

PLATFORM LOAD CELL

APPLICATIONS

- Single-point platform scales
- Bench, counting and deli scales
- Checkweighing scales
- Hopper scales and netweighing
- Belt conveyor scales

FEATURES

- Rated capacities of 25 to 100 pounds, 6 to 60 kilograms
- Stainless steel, welded seal construction
- Moment-compensated design for minimal sensitivity to moments induced by off-center loading
- Replacement for RTI model HPS and compatible load cells
- Exceeds NIST H-44 performance requirements
- Provides optimum performance under adverse loading conditions
- **Sensorgage™** sealed to IP67 standards
- **Cell Guard™** Two Year Warranty
 - Factory Mutual System Approved for Classes I, II, III; Divisions 1 and 2; Groups A through G.
 - Also, **Non-Incendive** ratings (No Barriers!)
- ISO 9001 Certified manufacturing facilities

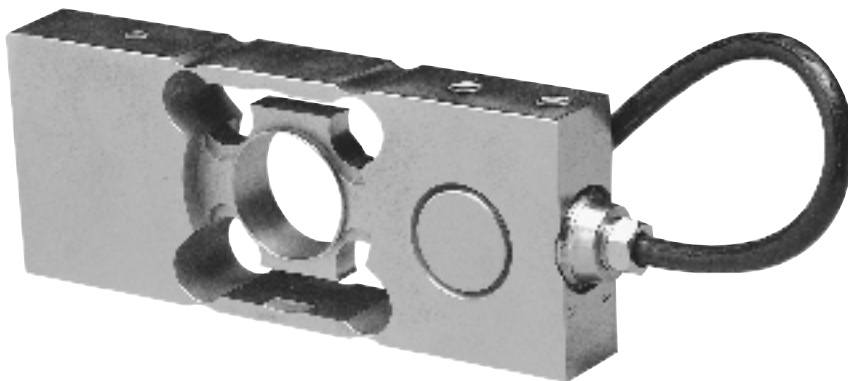

ISO
9001

Factory
Mutual
System
Approved



Model 60064 Performance Specifications

Rated Capacities (lbs): 25, 50, 100
 (kilograms): 6, 15, 60
 Full Scale Output (FSO): 3.0 mV/V \pm 0.25% (lbs)
 2.0 mV/V \pm 10% (kgs)

Accuracy Class:	<u>Standard</u>
Combined Error % FSO	\leq .03
Non-Linearity % FSO	\leq .03
Hysteresis % FSO	\leq .03
Creep Error % FSO	\leq .03 in 20 minutes
Temperature Effect on:	
• Zero % FSO/°F	\leq 0.0015
• Output % of Load/°F	\leq 0.0008
Non-Repeatability % FSO	\leq .01
Zero Balance % FSO	\leq 1.0
Insulation Resistance	> 1000 Mohms at 50 VDC
Compensated Temperature Range	0° to 150°F/ -15° to 65°C
Operating Temperature Range	-65° to 185°F/ -50° to 85°C
Storage Temperature Range	-65° to 185°F/ -50° to 85°C
Input Resistance	400 Ohms Nominal
Output Resistance	347 - 353 Ohms
Recommended Excitation Voltage	10 Volts DC
Maximum Excitation Voltage	15 Volts DC
Safe Overload	150% of Rated Capacity
Ultimate Overload	200% of Rated Capacity
Sealing	Meets IP67 Standards
Material	17-4 Stainless Steel
Moment Compensation:	
• Moment Sensitivity	\leq 0.01% of applied load per inch
• Maximum Moment (inch-lbs)	5 inches x capacity
• Platform Size (inches)	10 x 10

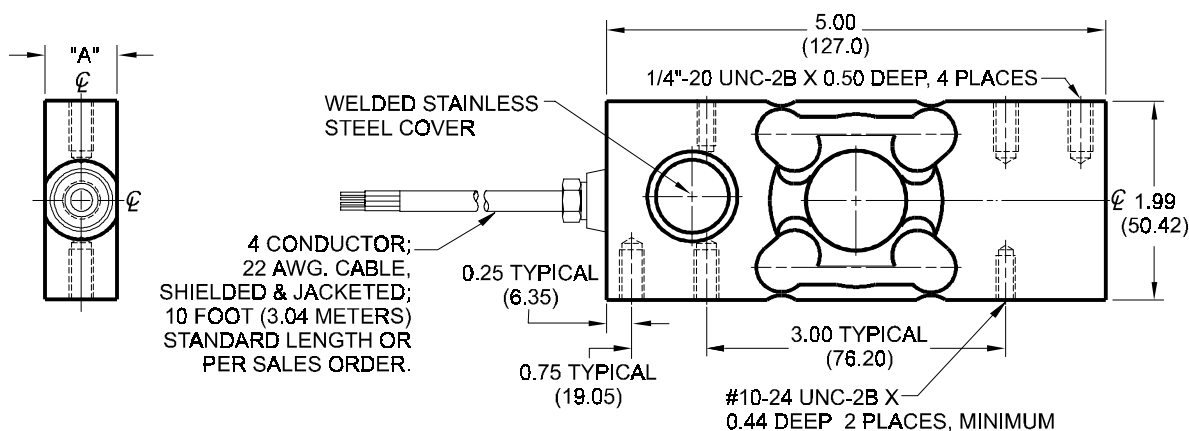

WIRING

FUNCTION	COLOR
+ Excitation	Green
- Excitation	Black
+ Output	White
- Output	Red

CAPACITY	A	Deflection	Weight
25 - 50 lbs.	0.72 (18.3)	0.011 (0.3)	1.7 (0.8)
100 lbs.	0.94 (23.9)	0.014 (0.4)	2.1 (1.0)
6 - 15 kgs.	0.72 (18.3)	0.007 (0.2)	1.7 (0.8)
60 kgs.	0.94 (23.9)	0.009 (0.2)	2.1 (1.0)

Dimensions are in inches (mm). Capacities are in pounds (kilograms). Deflection is \pm 10%. Specifications are subject to change. Certified drawings are available.