

Model 3510

Shear Beam Load Cells



Features

- ◆ Capacities: 500 - 5000 kg (1102.29 - 11022.93 lbs)
- ◆ Stainless steel construction
- ◆ Combined error only 0.02%
- ◆ Hermetically sealed to IP68
- ◆ 6 Wire (sense) circuit
- ◆ Interchangeable with Model 3410 and other
- ◆ industry standard configuration load cells
- ◆ Fully welded protection
- ◆ Hostile environment capability

Model 3510 is a hermetically sealed, stainless steel shear beam. Designed for the ultimate protection necessary for today's hostile environments, it is ideally suited for low profile platforms, pallet truck weighers, tanks and silos.

This high accuracy load cell is hermetically sealed to IP 68 and is OIML Class C3 Approved. When operated at constant temperature, all load cells offer 0.02% combined error performance regardless of accuracy class.

Hermetically sealed, stainless steel construction assures long-term stability even under harsh environment and extreme temperatures. The slotted profile enables manufacturers to easily position the load cell without resorting to the use of mounting plates.

For tank or hopper mounting applications, Tedeo-Huntleigh offers the Model 9100 Series Cell-Mates. Cell-Mates simplify mounting while increasing system accuracy.

TEDEA **th**
HUNTLEIGH
EXCELLENCE IN LOAD CELLS

INTERTECHNOLOGY
INC.

1 Scarsdale Road, Don Mills, ON M3B 2R2
Tel: 416-445-5500, Fax: 416-445-1170
Toll Free: 1-800-465-1600
E-Mail: sales@intertechnology.ca

Model 3510

Shear Beam Load Cells

GRADE	E	F	UNITS
Accuracy Class	500, 1000, 2000, 5000		kg
Rated Capacity	2.0 ± 0.25%		mV/V
Rated Output*	0.050	0.025	±% of Applied Load
Total Error**	0.040	0.025	±% of Applied Load
Total Error	0.0030	0.0015	±% of Applied Load / °C
Creep at Rated Capacity / Zero Return After 30 Minutes	0.0050	0.0026	±% of Rated Load Output / °C
Zero Balance	1.0		±% of Rated Output
Temperature Range: Safe	-30 to +70		°C
Temperature Range: Compensated	-10 to +40		°C
Temperature Effect: On Output	150		% of Rated Capacity
Temperature Effect: On Zero	300		% of Rated Capacity
Maximum Overload at the Center Loading Point	10		Volts AC or DC
Ultimate Overload at the Center Loading Point	15		Volts AC or DC
Excitation: Recommended	420 ± 20		Ohms
Excitation: Maximum	350 ± 3		Ohms
Input Impedance	>1000		Mega Ohms
Output Impedance	<0.4		mm
Insulation Resistance	2.5		kg
Deflection at Rated Capacity	4.5		kg
Weight: 500 - 2000 kg	Stainless Steel		
Weight: 5000 kg	IP68		
Construction	5 Meters (Standard), 6 Wire Polyurethane Jacket, Dual Floating Screen		
Cable	EEx ia IIC T6		

*All accuracy specifications maintained when 150% of nominal load is applied for 3 mV/V output.

Wiring Schematic Diagram

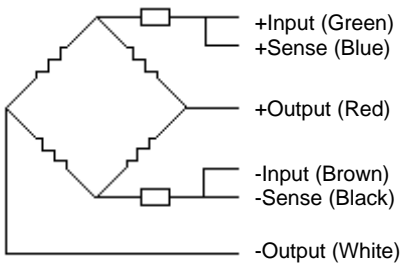

The two "sense" wires sample the bridge supply voltage at the load cell. Complete compensation of change in the lead wire resistance, due to temperature change and/or cable extension, is achieved by feeding this voltage into appropriate electronics.

Outline Dimensions All Capacities (in inches unless otherwise specified.)

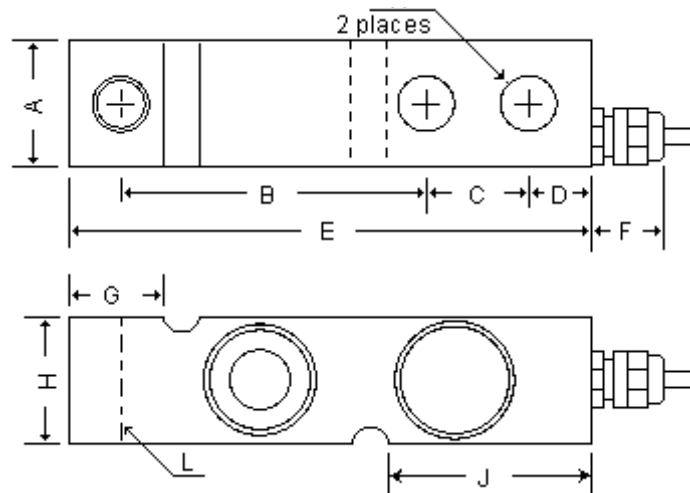

Capacity	A	B	C	D	E	F	G	H	J	K	L
500 - 2000 kg	1.26	3.00	1.00	0.62	5.12	0.71	0.93	1.26	1.99	13.5 mm	1/2"-20 UNF M12 X 1.75
5000 kg	1.44	3.75	1.50	0.75	6.75	0.71	1.46	1.89	2.76	20.5 mm	3/4"-16 UNF 20.5 mm